



SORBAVIEW SHIELD IS A ONE-STEP CATHETER SECUREMENT SYSTEM THAT COMBINES THE FEATURES AND BENEFITS OF A SORBAVIEW DRESSING WITH SHIELD TECHNOLOGY.

APPLICATION

Prep well **beyond** entire dressing site according to facility protocol to ensure dressing adherence. **Allow prep to dry completely** per manufacturer's instructions. Note: If the prep doesn't dry completely, the integrity and security of the dressing may be compromised. A skin protectant may be used according to preference or protocol. **Allow skin protectant to dry completely.**

Note: Liner has a label attached that can be used later to record information. Remove larger liner without touching adhesive (set aside liner). Place dressing so the insertion site is viewable in window and **the luer lock connection is under or inside the blue line at the base of the window (Figure A)**. Adhere dressing to skin.

Remove remaining liner and guide the tubing out through notch. Either overlap or pinch the edges of the notch together to form a seal (**Figure B1**). Notch edges should be touching or overlapping (**Figure B**). From center outward, firmly smooth down entire dressing to ensure all edges are adhered well.

Without removing the liner, firmly and snugly slip closure piece **under** tubing and **over** edge of dressing (**Figure C**). Remove the liner one side at a time and smooth down to adhere.

Record information on label, remove from liner and position label on the edge of the dressing.

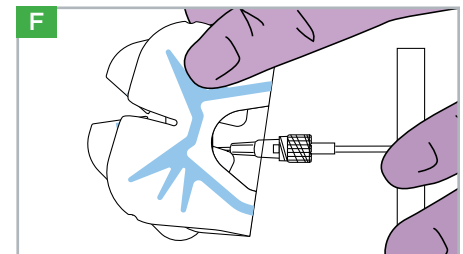
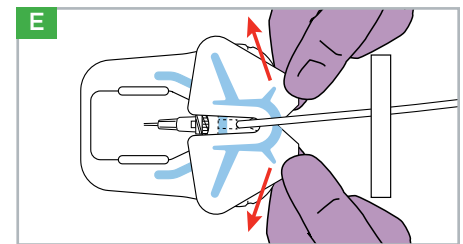
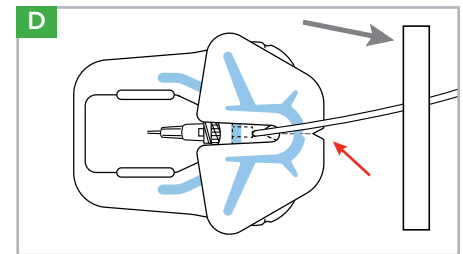
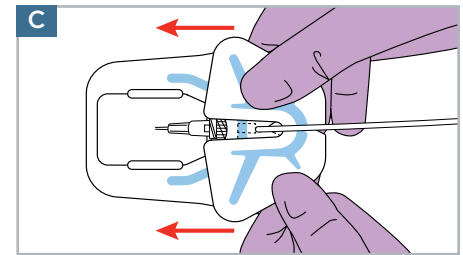
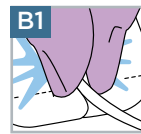
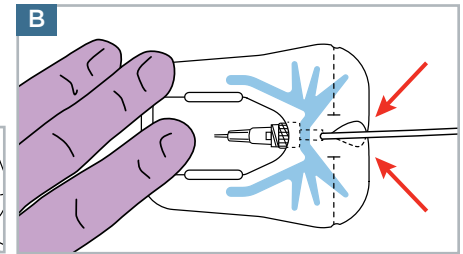
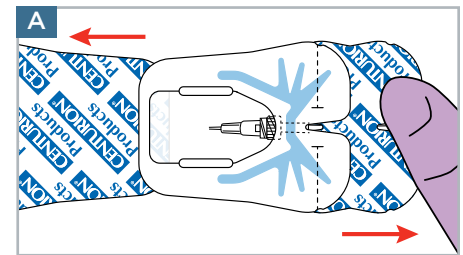

REMOVAL

Optional: A tape strip may be used to secure catheter tubing during removal (**Figure D**).

Optional: Use an alcohol prep pad **underneath** dressing while peeling back to help deactivate the adhesive or per hospital protocol.

Locate v-notch on outer edge of closure piece (**Figure D**) and pull apart in opposite directions to break center perforations (**Figure E**).

Holding the catheter in place, gently peel back closure piece and dressing together as one. Peel back slowly, keeping dressing close to the skin, following catheter toward insertion site (**Figure F**).

SorbaView SHIELD and SHIELD Technology are the proprietary property of Centurion Medical Products. SorbaView SHIELD is only available in sterile individual packs or sterile trays manufactured by Centurion Medical Products.

CENTURION MEDICAL PRODUCTS

100 CENTURION WAY | WILLIAMSTON | MICHIGAN | 48895
USA | 800.248.4058 | www.centurionmp.com | www.sorbaviewshield.com

SV118 | UD29
IS459aLv1_SV118 straight 0728-14
©2014 Centurion Medical Products Corporation