

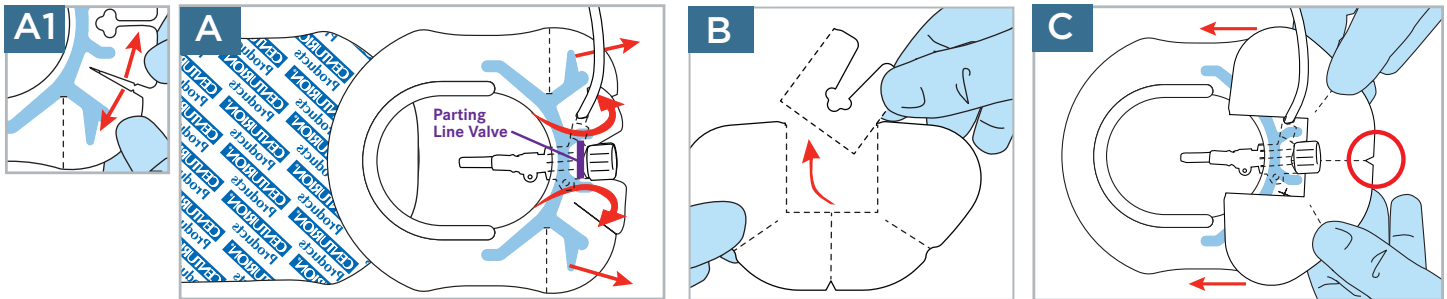

SORBAVIEW SHIELD IS A ONE-STEP CATHETER SECUREMENT SYSTEM THAT COMBINES THE FEATURES AND BENEFITS OF A SORBAVIEW DRESSING WITH SHIELD TECHNOLOGY.

APPLICATION

Prep well beyond entire site according to facility protocol.
Allow prep to dry completely. This usually takes less than one minute.



Break apart tab at diagonal slits only on side with tubing (Figure A1).

Align center notch to catheter's parting line valve. Remove larger liner without touching adhesive. Press to adhere to catheter and skin.

Remove small liner. On tubing side, adhere outer tab and guide tubing out through slit. Overlap inner tab and press to adhere (Figure A). Next, adhere opposite side of dressing.

Tear center perforated square from closure piece and discard (Figure B).

Without removing the liner, slip the closure piece **under** tubing and **over** edge of dressing as far as possible (Figure C). Remove the liner one side at a time and smooth down to adhere.

REMOVAL

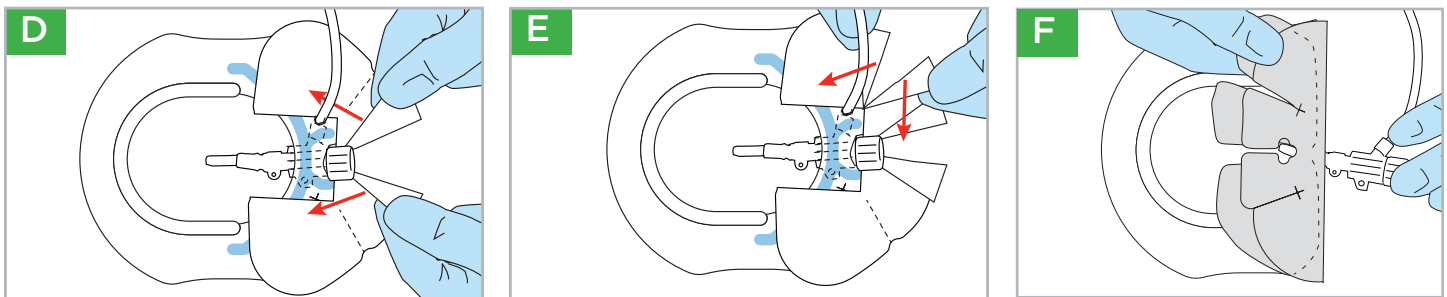

Locate v-notch on outer edge of closure piece and pull apart in opposite directions to break center perforation (Figure D).

Locate side c-notch and break apart diagonal perforation and pull apart completely (Figure E).

Holding the introducer in place, gently peel back closure piece and dressing together as one. Peel back slowly, keeping dressing close to the skin, following catheter toward insertion site (Figure F).

SorbaView SHIELD and SHIELD Technology are the proprietary property of Centurion Medical Products.
SorbaView SHIELD is only available in sterile individual packs or sterile trays manufactured by Centurion Medical Products.

CENTURION MEDICAL PRODUCTS

100 CENTURION WAY | WILLIAMSTON | MICHIGAN | 48895
USA | 800.248.4058 | www.centurionmp.com | www.sorbaviewshield.com

IS393cLv2_SV430_pictorial_Introducer
051612
©2012 Centurion Medical Products Corporation