

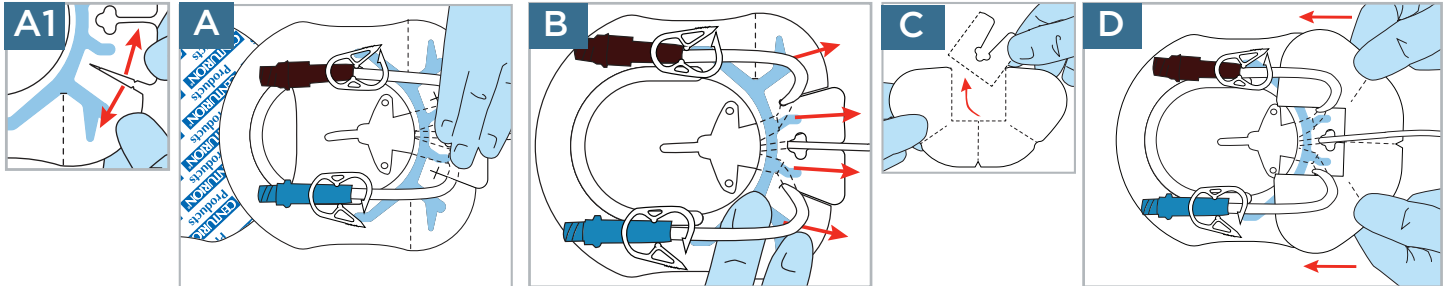

SORBAVIEW SHIELD IS A ONE-STEP CATHETER SECUREMENT SYSTEM THAT COMBINES THE FEATURES AND BENEFITS OF A SORBAVIEW DRESSING WITH SHIELD TECHNOLOGY.

**APPLICATION**

Prep well beyond entire site according to facility protocol.  
 Allow prep to dry completely. This usually takes less than one minute.



Break apart tabs at diagonal slits (**Figure A1**).  
 Pull the outer curved lumens into the dressing slots as far as possible. Remove larger liner without touching adhesive and adhere dressing to catheter and skin (**Figure A**).

To remove smaller liner, first remove the side lumens from the dressing slots, then remove liner.

Relocate the outer curved lumens into dressing slots and adhere outer tabs (**Figure B**). Adhere inner tabs to skin.

Tear center perforated square from closure piece and discard (**Figure C**).

Without removing the liner, slip the closure piece **under** tubing and **over** edge of dressing as far as possible (**Figure D**). Remove the liner one side at a time and smooth down to adhere.

**REMOVAL**

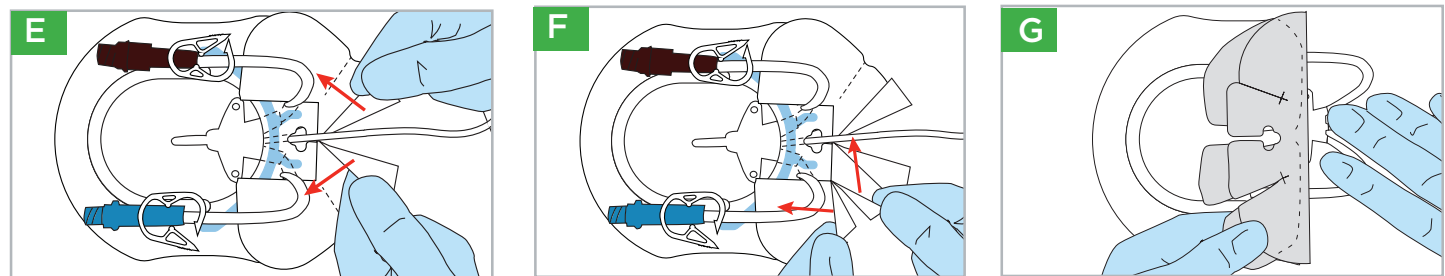

Locate v-notch on outer edge of closure piece and pull apart in opposite directions to break center perforation (**Figure E**).

Locate side c-notch. Break apart diagonal perforation and pull apart completely (**Figure F**). Repeat on other diagonal perforation.

Holding the catheter in place, gently peel back closure piece and dressing together as one. Peel back slowly, keeping dressing close to the skin, following catheter toward insertion site (**Figure G**).

SorbaView SHIELD and SHIELD Technology are the proprietary property of Centurion Medical Products.  
 SorbaView SHIELD is only available in sterile individual packs or sterile trays manufactured by Centurion Medical Products.